

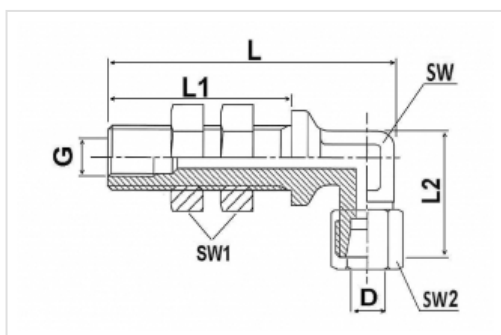

HÅFSTRÖMS

## Bulkheads 24° elbow - female thread greasing aid

DIN 2353 ISO 8434-1



Steel, surface zinc-nickel / chrome-VI free

Item No.	D	G	L	L1	L2	SW	SW1	SW2	Serie	Bag	Box
1019-001	6	M 6 x 1	54	34	24	12	17	14	L	10	250

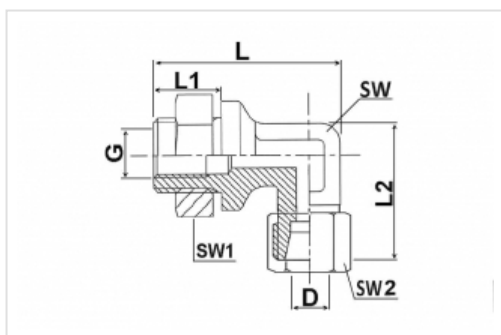

Steel, surface zinc-nickel / chrome-VI free

Item No.	D	G	L	L1	L2	SW	SW1	SW2	Serie	Bag	Box
1019-002	6	M 6 x 1	30	11	24	12	17	14	L	10	250



## HÅFSTRÖMS

Bulkhead fittings with grease nipples are used wherever lubrication points (bearings, threads...) are difficult to access, for ex. behind covers, protective walls or similar devices.

The usage can be the classic manual lubrication or an emergency lubrication function, which plays an important role in a central lubrication system.



Our lubrication aid, bulkhead fitting with grease nipple, is the „fitting duo“ for all common grease guns. The grease is fed to the lube point via the grease nipple and through the bulkhead screw connection.

Either the bulkhead is screwed directly on the lubrication point with a cutting ring fitting or a connection with the help of a high pressure hose or a plastic tube is needed.

For the maintenance and servicing of lubrication systems in construction machinery and construction vehicles, ... but also in industrial plants, the bulkhead screw connection with lubrication function is essential.